

SITE LOCUS
N.T.S.

CONSTRUCTION NOTES

1. THE PROPOSED WORK IS SUBJECT TO AN AMENDED ORDER OF CONDITIONS FROM THE TOWN OF STOW CONSERVATION COMMISSION. CONTRACTOR SHALL OBTAIN A COPY OF THE AMENDED ORDER AND ABIDE BY ALL CONDITIONS.
2. CONTRACTOR TO INSTALL EROSION CONTROL BARRIERS IN ALL WORK AREAS AS NEEDED TO PREVENT RUNOFF OF MUDDY SOIL INTO THE LAKE. REVIEW LOCATIONS WITH DESIGNER PRIOR TO PROCEEDING WITH THE WORK.
3. CONTRACTOR TO INSTALL THE BUFFER ZONE PLANTING AREA AS NOTED ON PLANTING PLAN & AS PER DIRECTION OF ORDER OF CONDITIONS.
4. CONTRACTOR TO RESTORE ALL OTHER DISTURBED AREAS TO THEIR ORIGINAL OR PROPOSED GRADE AND LOAM & SEED WITH A SUN/SHADE GRASS SEED MIX.

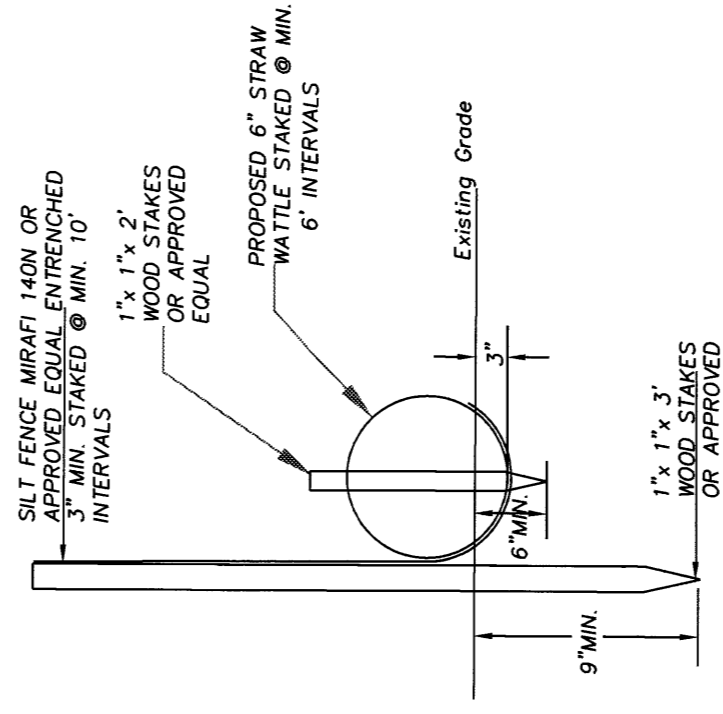

STRAW WATTLE & SILT FENCE DETAIL
N.T.S.

PROPERTY REFERENCES

DEED REFERENCE
BOOK 73978 / PAGE 285
VERTICAL DATUM-ASSUMED
ASSESSORS MAP U4
PARCEL 39
ZONING DISTRICT: SB

NOTE: ALL UNDERGROUND UTILITY LOCATIONS AND ELEVATIONS ARE APPROXIMATE AND MUST BE VERIFIED AT TIME OF CONSTRUCTION.
CALL DIG SAFE: 1-888-344-7233

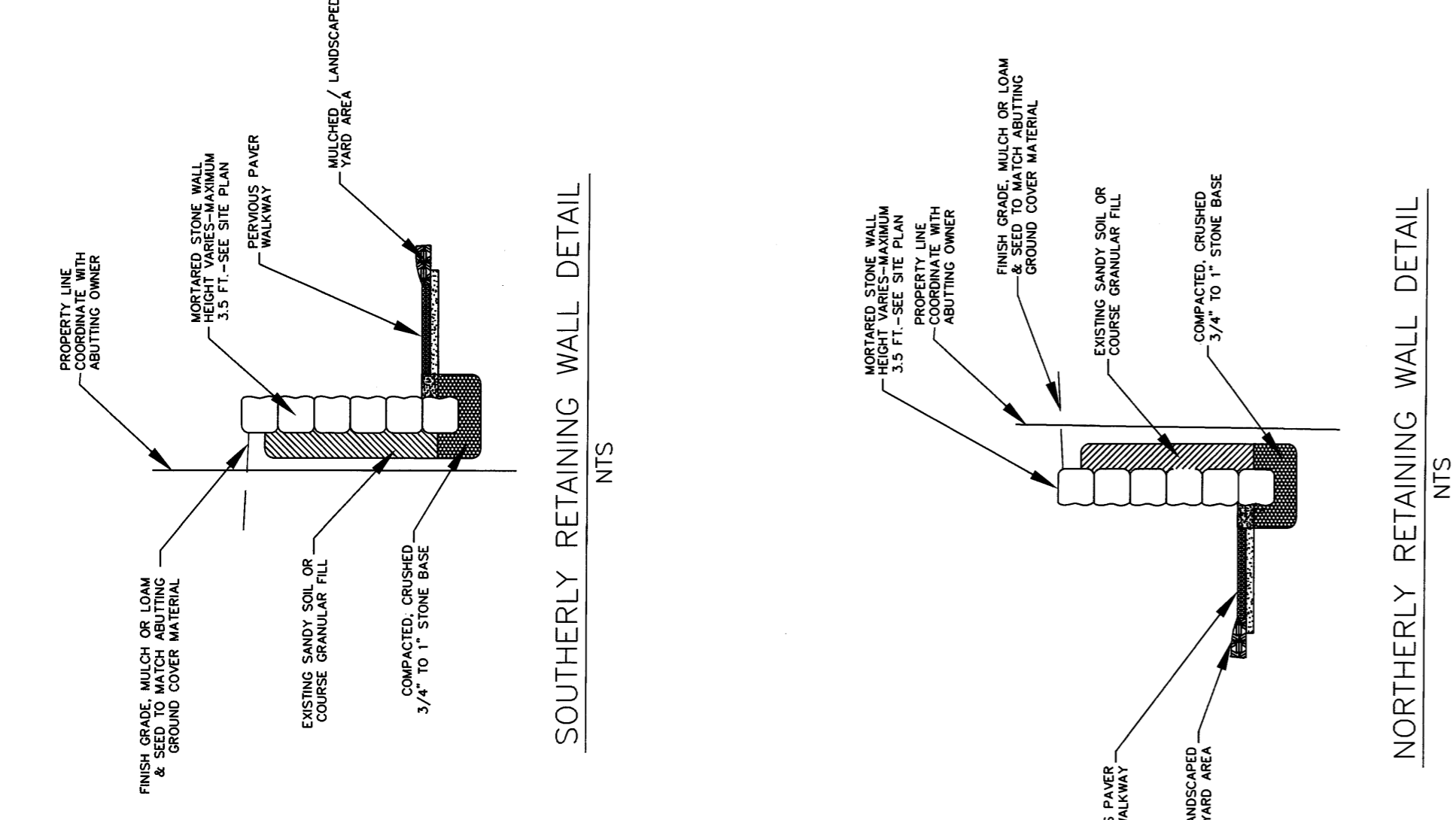
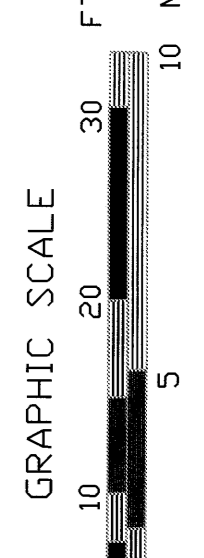
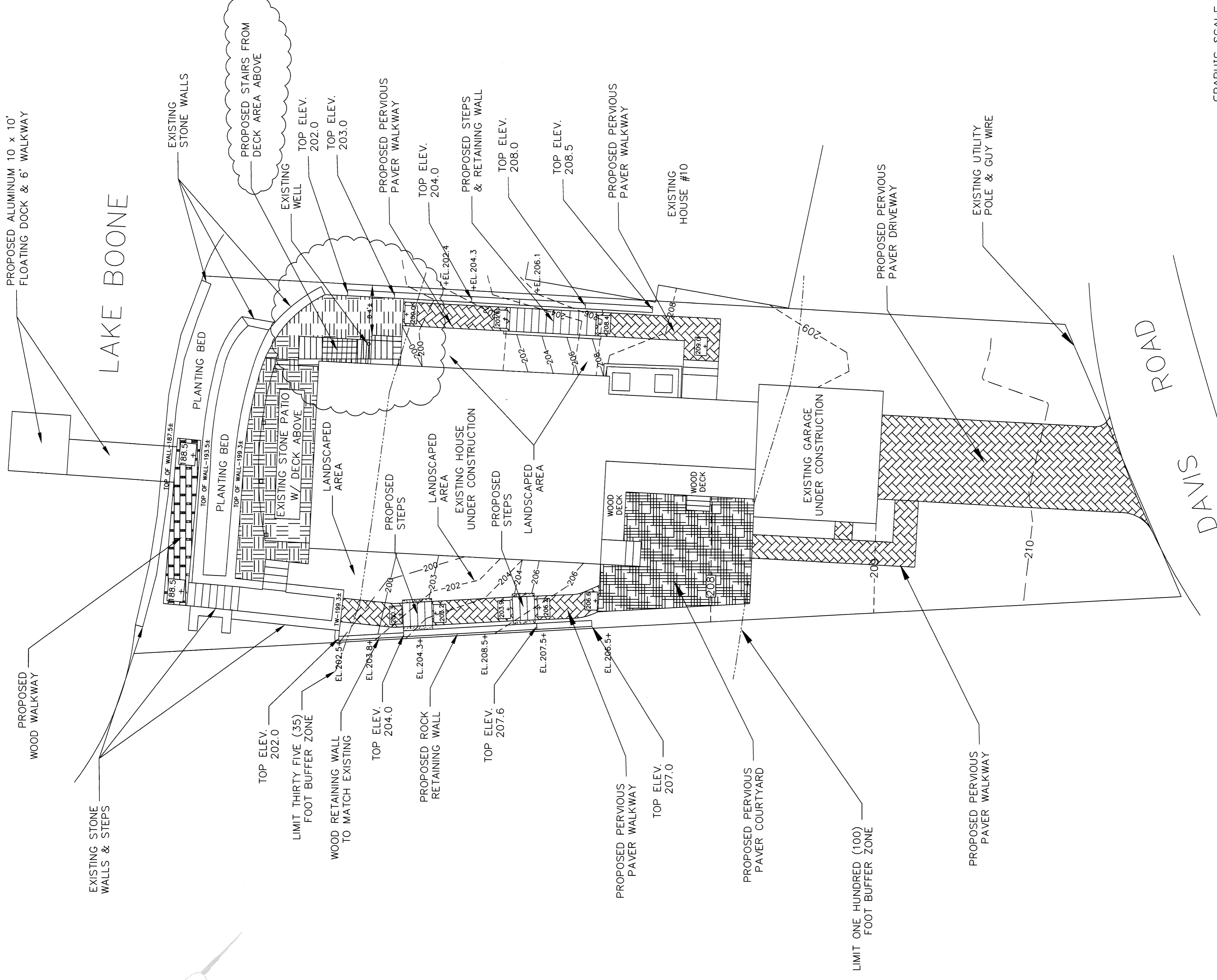

APPLICANT: K. ANDREW & TANIA BORG
44 PINE STREET
SUDBURY, MA 01776

SITE PLAN MODIFICATION 8 DAVIS ROAD STOW, MASSACHUSETTS

SCALE: 1"=10' DATE: MAY 26, 2021

PREPARED BY:
LAKEVIEW ENGINEERING ASSOCIATES
CIVIL ENGINEERING & ENVIRONMENTAL PERMITTING
P.O. BOX 787 HUDSON, MA 01749
(508) 232-8302

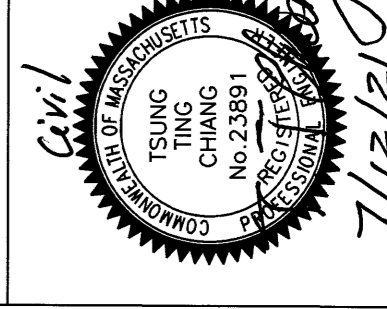

DESIGNED BY: S.E.P.	DRAWN BY: S.E.P.	CHECKED BY: E.T.T.C.
3.	ADDED ZBA INFORMATION	7/7/21
2.	ADDED WALL DETAILS, SPOT GRADES & REV. WALKWAYS	6/8/21
1.	ADDED DECK STAIRS & MISC. NOTES	5/31/21
No.	DESCRIPTION	DATE
	REVISIONS	

C:\SSSK PROJ\ 8 - DAVIS / DWG / SITE MOD SHEET 1 OF 1