

ZONING DISTRICT

RESIDENTIAL

REFERENCE

- DEED BOOK 35147 PAGE 162
- PLAN No. 1414 OF 1947
- PLAN No. 1689 OF 1948
- PLAN No. 694 OF 1948
- PLAN No. 1104 OF 1981
- PLAN No. 670 OF 1982
- PLAN No. 880 OF 1987
- PLAN No. 784 OF 1998
- PLAN No. 154 OF 1977
- PLAN No. 1527 OF 1955
- PLAN No. 1072 OF 1987
- PLAN No. 340 OF 1972
- PLAN No. 856 OF 1976
- PLAN No. 271 OF 1994

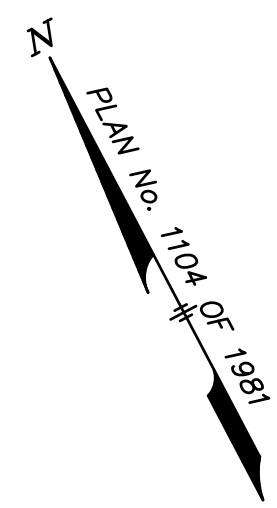

PROPOSED PLOT PLAN
IN
STOW, MASSACHUSETTS
(MIDDLESEX COUNTY)

FOR: **RODSTROM**
SCALE: 1"=20' JULY 21, 2020

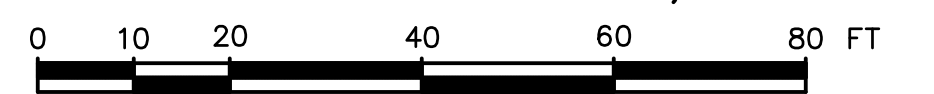

STAMSKI AND MCNARY, INC.
1000 MAIN STREET ACTON, MASSACHUSETTS
ENGINEERING - PLANNING - SURVEYING