

**ZONING DISTRICT**

RESIDENTIAL

**REFERENCE**

- DEED BOOK 35147 PAGE 162
- PLAN No. 1414 OF 1947
- PLAN No. 1689 OF 1948
- PLAN No. 694 OF 1948
- PLAN No. 1104 OF 1981
- PLAN No. 670 OF 1982
- PLAN No. 880 OF 1987
- PLAN No. 784 OF 1988
- PLAN No. 154 OF 1977
- PLAN No. 1527 OF 1955
- PLAN No. 1072 OF 1987
- PLAN No. 340 OF 1972
- PLAN No. 856 OF 1976
- PLAN No. 271 OF 1994

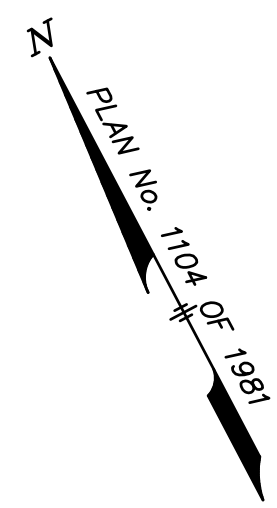

PROPOSED PLOT PLAN  
IN  
**STOW, MASSACHUSETTS**  
(MIDDLESEX COUNTY)

FOR: RODSTROM  
SCALE: 1"=20' JULY 21, 2020

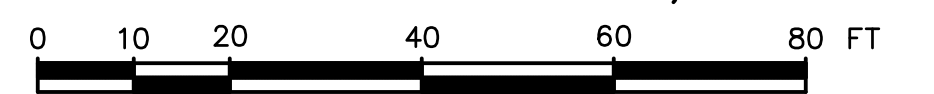

**STAMSKI AND MCNARY, INC.**  
1000 MAIN STREET ACTON, MASSACHUSETTS  
ENGINEERING - PLANNING - SURVEYING