

LEGEND:

- A ● B TIME OF CONCENTRATION
--- SUBCATCHMENT DIVIDE
--- SOIL DIVIDE
256A SOIL UNIT SYMBOL
E-1 SUBCATCHMENT DESIGNATION
- - - - - BORDERING VEGETATED WETLAND
- - - - - MEAN ANNUAL HIGH WATER
- - - - - 35-FOOT NO-DISTURB ZONE
- - - - - BUFFER ZONE
- - - - - RIVERFRONT AREA
- - - - - EXISTING CONTOUR
○○○○○ STONE WALL
N/F NOW OR FORMERLY
● TREE
~ TREE LINE
■ ROOF AREA DIRECTED TO INDIVIDUAL DRYWELL

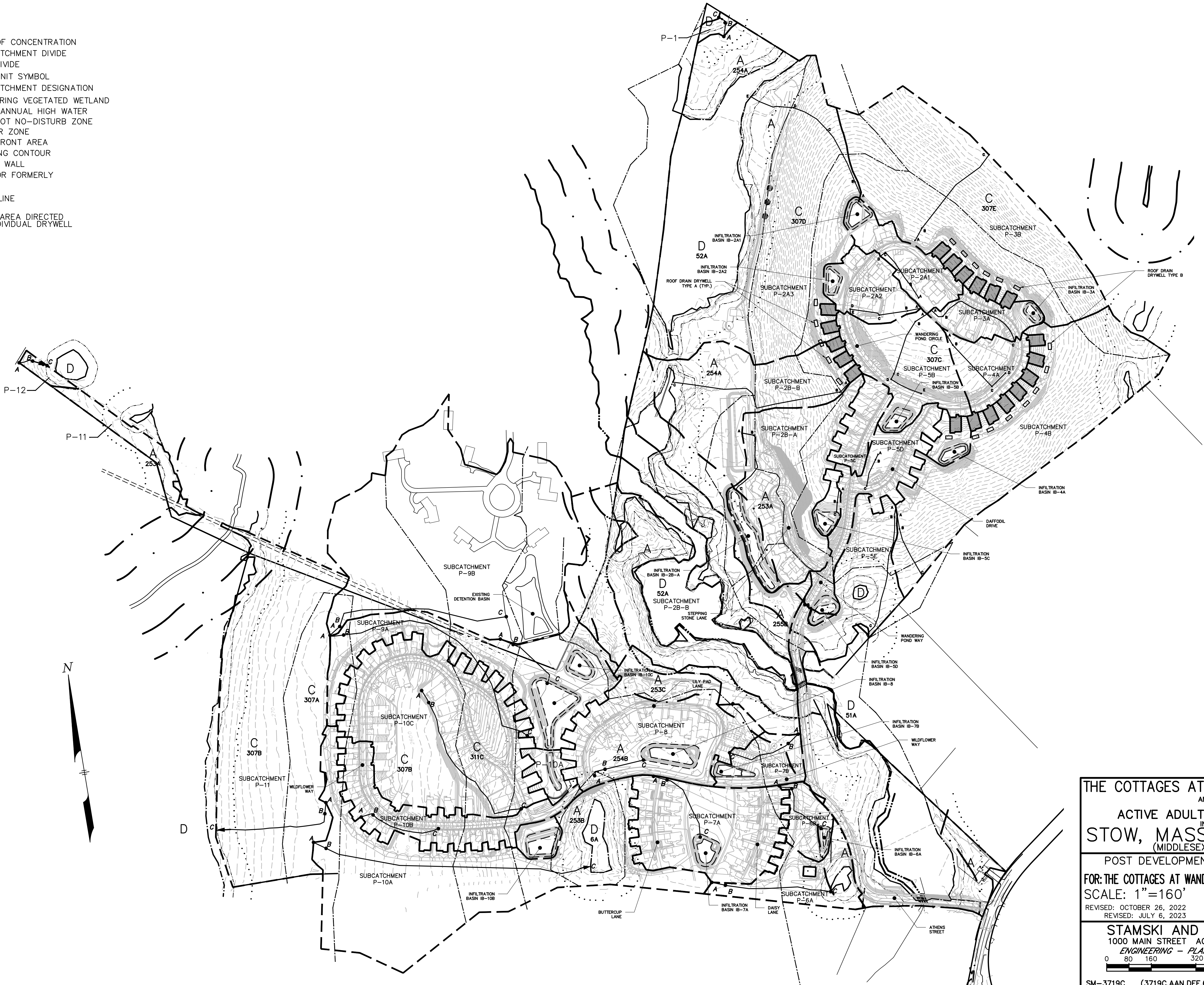

THE COTTAGES AT WANDERING POND
AN
ACTIVE ADULT NEIGHBORHOOD
IN
STOW, MASSACHUSETTS
(MIDDLESEX COUNTY)
POST DEVELOPMENT DRAINAGE MAP
FOR: THE COTTAGES AT WANDERING POND REALTY TRUST
SCALE: 1"=160' JUNE 30, 2022
REVISED: OCTOBER 26, 2022 REVISED: FEBRUARY 16, 2024
REVISED: JULY 6, 2023
STAMSKI AND McNARY, INC.
1000 MAIN STREET ACTON, MASSACHUSETTS
ENGINEERING - PLANNING - SURVEYING
0 80 160 320 480 640 FT
SM-3719C (3719C.AAN.DEF.6.Post Dev Map.dwg)