

# RANDALL LIBRARY FINAL DESIGN WORKSHOP

9/13/2023

CONSTRUCTION DOCUMENT WORKSHOP 8

STOW, MA



designLAB architects

G2 G2 COLLABORATIVE  
LANDSCAPE ARCHITECTURE



# RANDALL LIBRARY PRELIMINARY DESIGN SUMMARY

CONSTRUCTION DOCUMENT WORKSHOP 8  
STOW, MA

## designLAB architects Team:

Ben Youtz, Partner  
Andrew Brookes, Architect  
Audrey Scanlon, Designer

## G2 Collaborative Team:

Gigi Saltonstall  
Alison Goyer

## Consultants:

Fitzmeyer + Tocci Associates  
RGE Structural Engineers  
Nitsch Engineers



designLAB architects

G2 G2 COLLABORATIVE  
LANDSCAPE ARCHITECTURE



# Today's Agenda

## Introduction

- Review Work Plan + Process Updates

## 65% Estimate Review

## Interior Characteristic

## Exterior Characteristic

## Discussion + Next Steps

# SCHEDULE

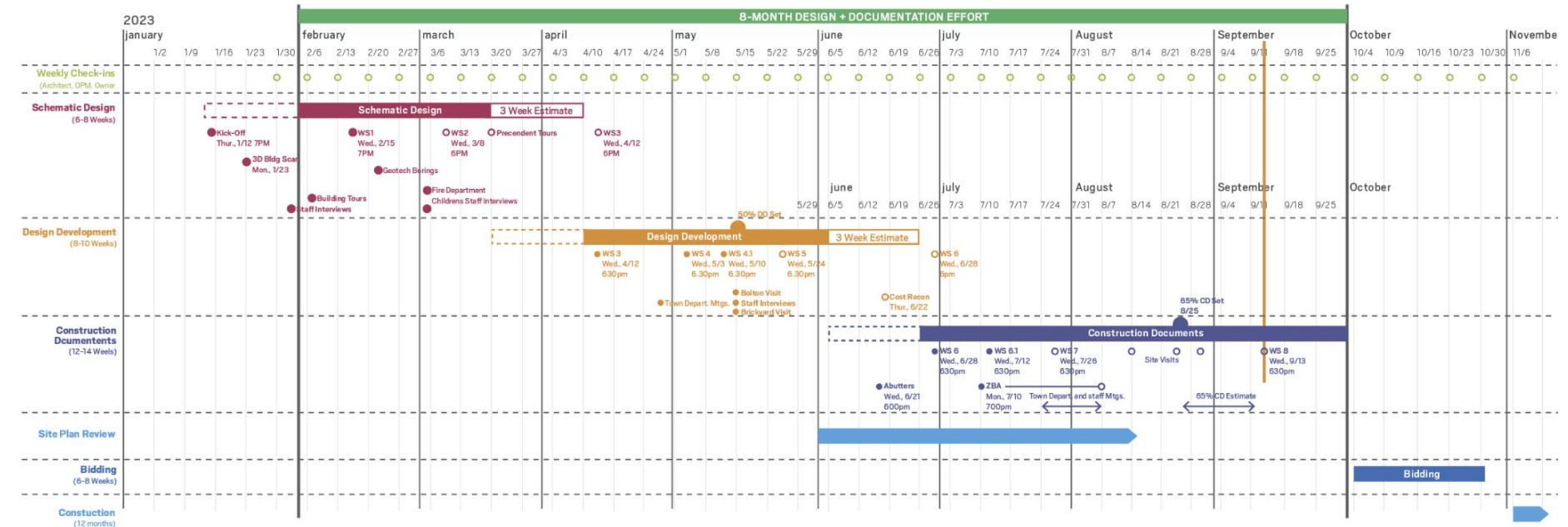



SCHEDULE

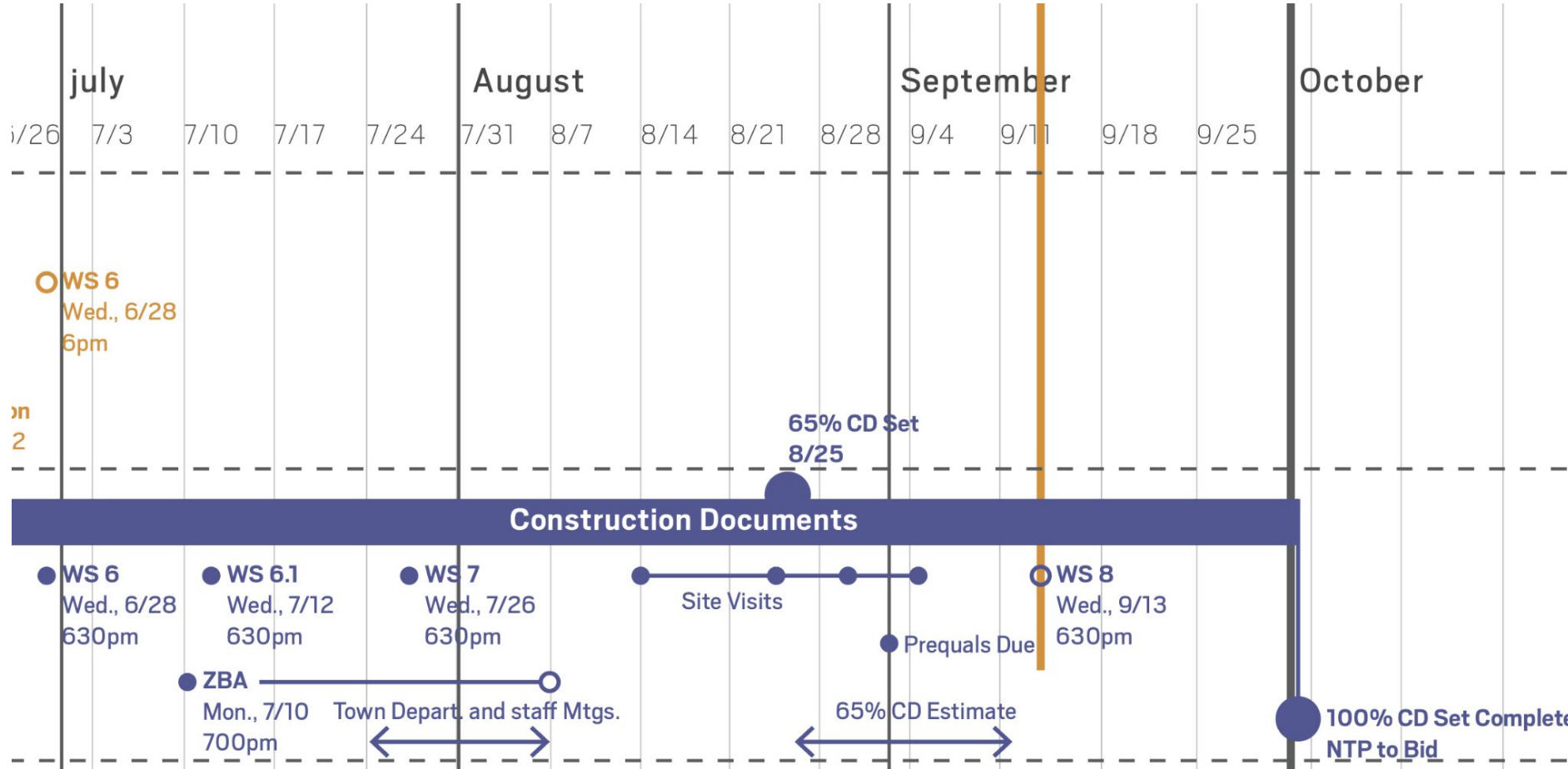



















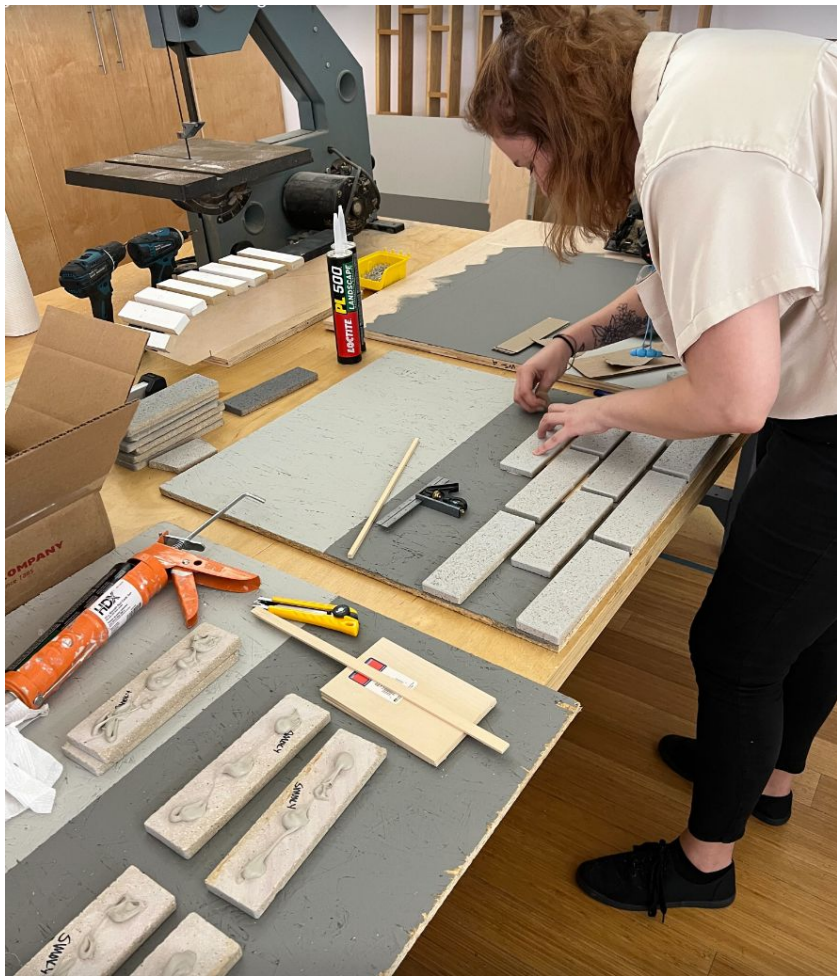



# Today's Agenda

## Introduction

- Review Work Plan + Process Updates

## 65% Estimate Review

## Interior Characteristic

## Exterior Characteristic

## Discussion + Next Steps





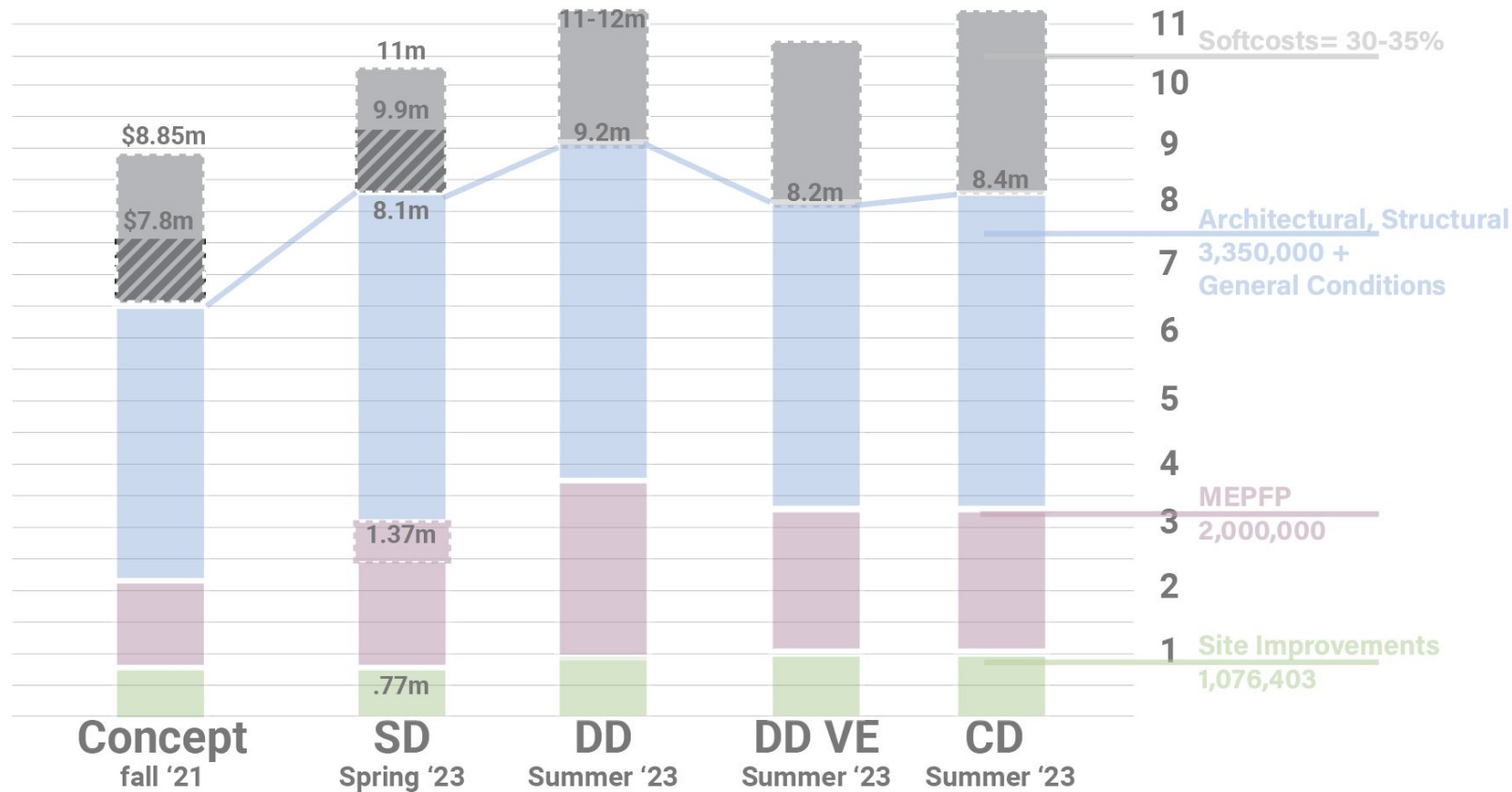

# VALUE MANAGEMENT STRATEGIES

- Change from Custom HVAC system
- Remove EV Charging Station
- Keep Light Fixtures in Historic Rooms
- Substitute Underpinning for Grade Beams
- Prefabricated Stone Site Walls Instead of Brick
- Reduce Landscape Plantings and Hardscape
- Reduce Impervious Areas
- Simplify/Reduce Finishes
- Reduce Refinishing of Existing Woodwork
- Change to Demountable Storefront System
- Change to Metal Perimeter Shelving
- Hydraulic Elevator Instead of Traction
- Remove Book Security Gates
- Reduce Double Height Spaces
- Reduce Window Shades
- Alt Cladding at Comm Room Volume
- Reduced Height of Comm Room Volume
- Reduced Footprint of Comm Room
- Simplify Roof Geometry from steel to wood
- Remove Lower Level Breakroom Bump Out

**TARGET REDUCTION: \$802.6K - \$855.9K**



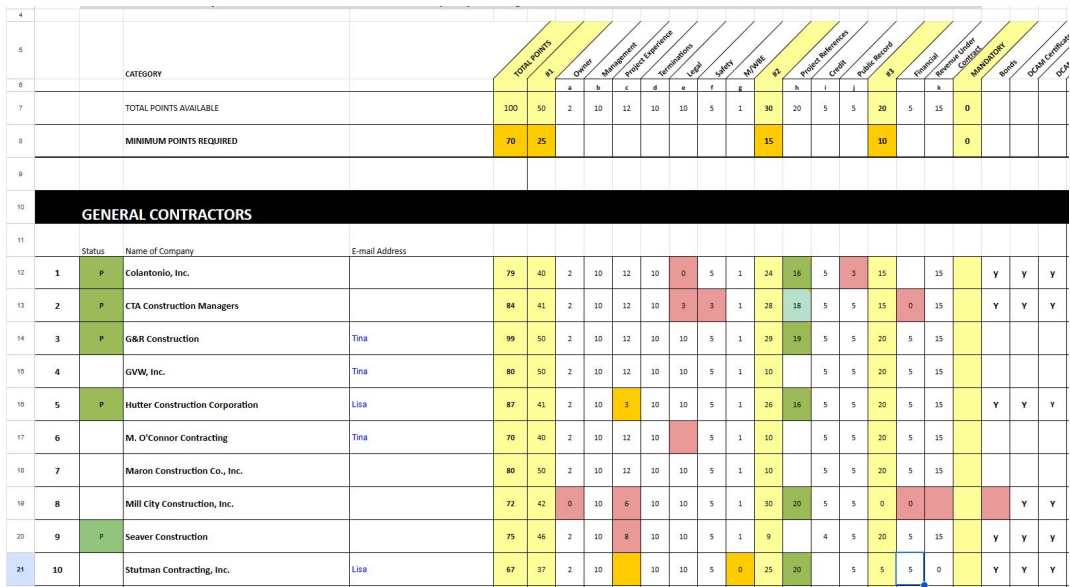

# Today's Agenda

## Introduction

- Review Work Plan + Process Updates

## 65% Estimate Review

## Interior Characteristic

## Exterior Characteristic

## Discussion + Next Steps





# UPDATED PLAN - LOWER LEVEL

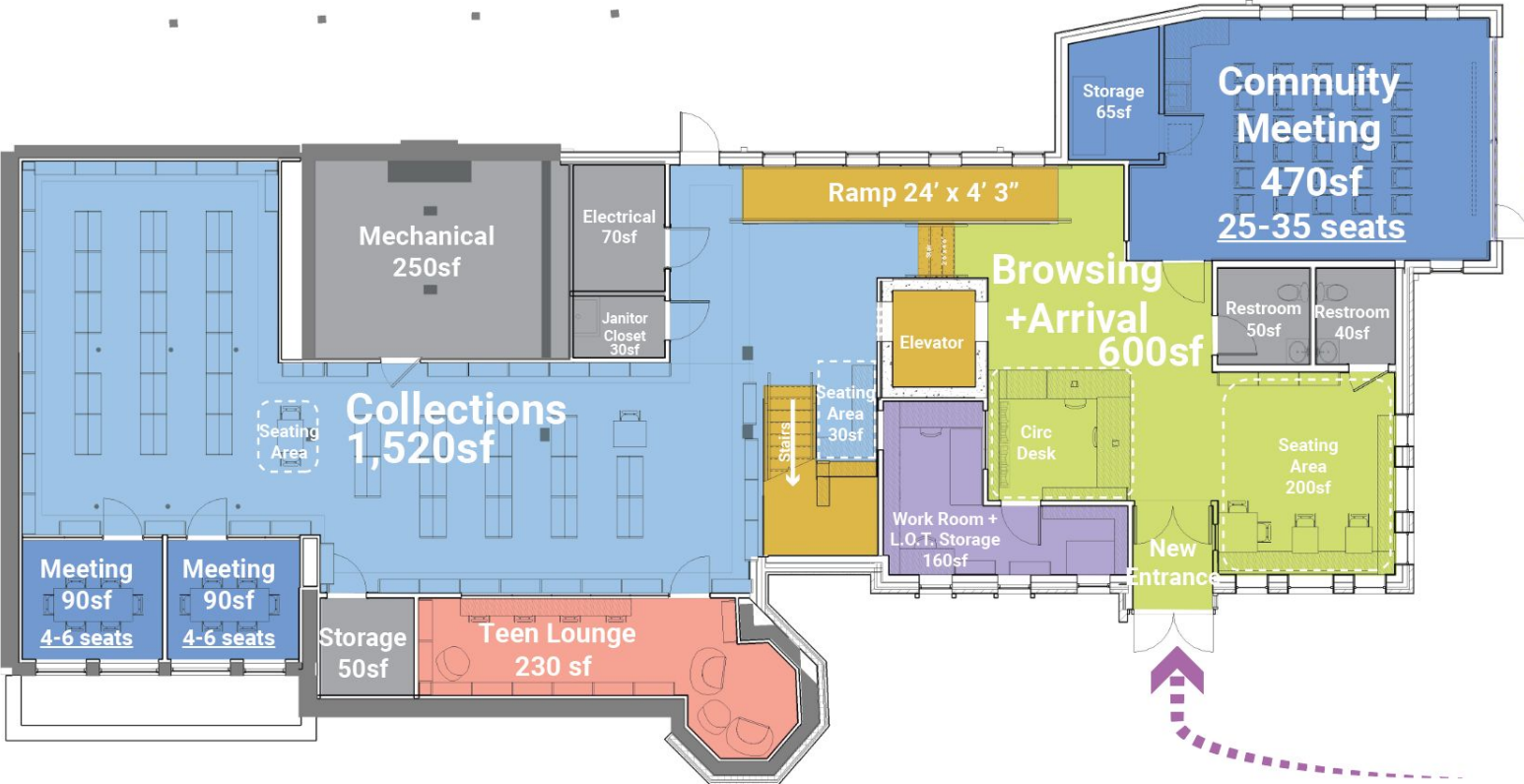

# UPDATED PLAN - UPPER LEVEL

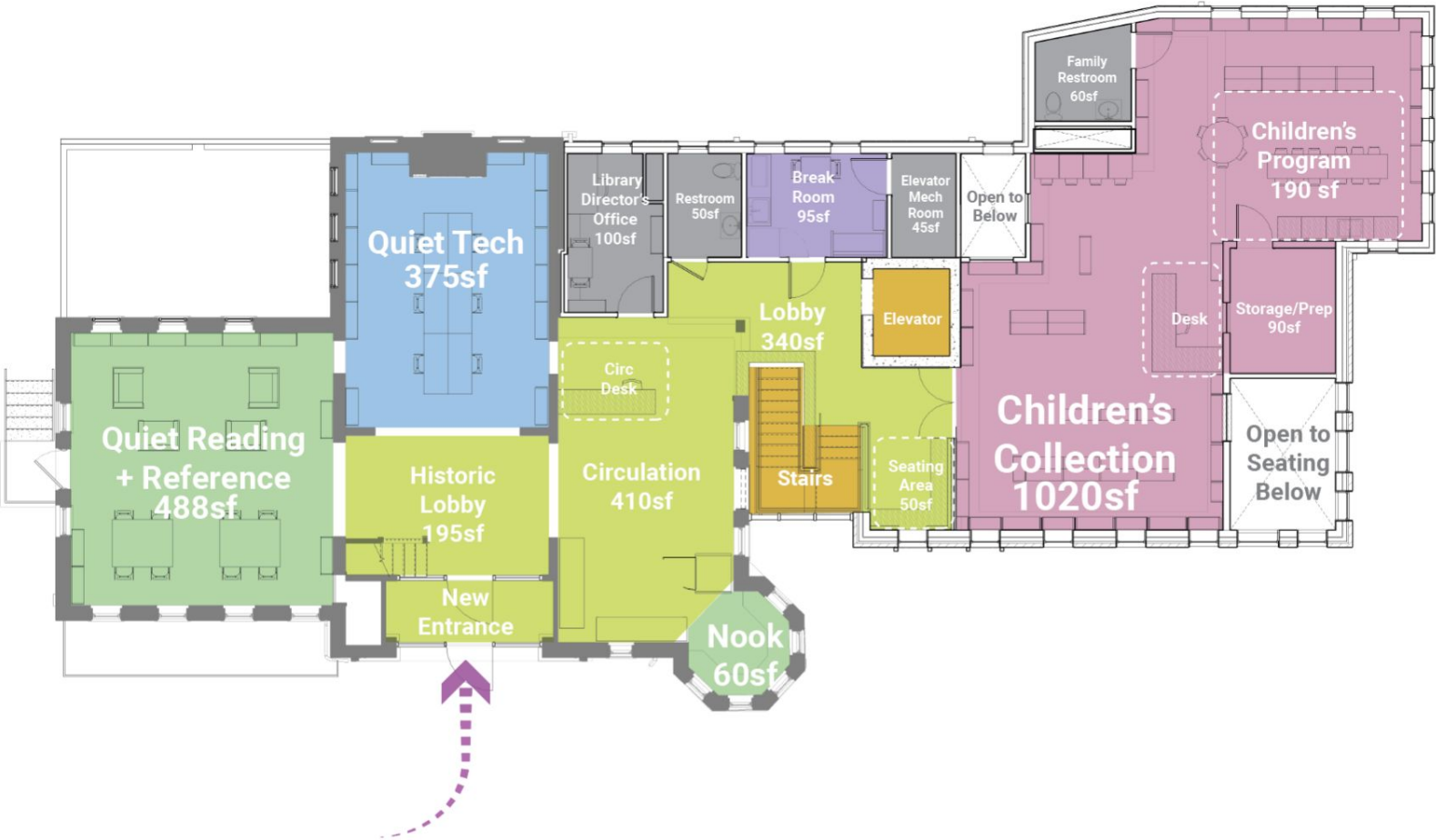



**FINISH PLAN - LOWER LEVEL**

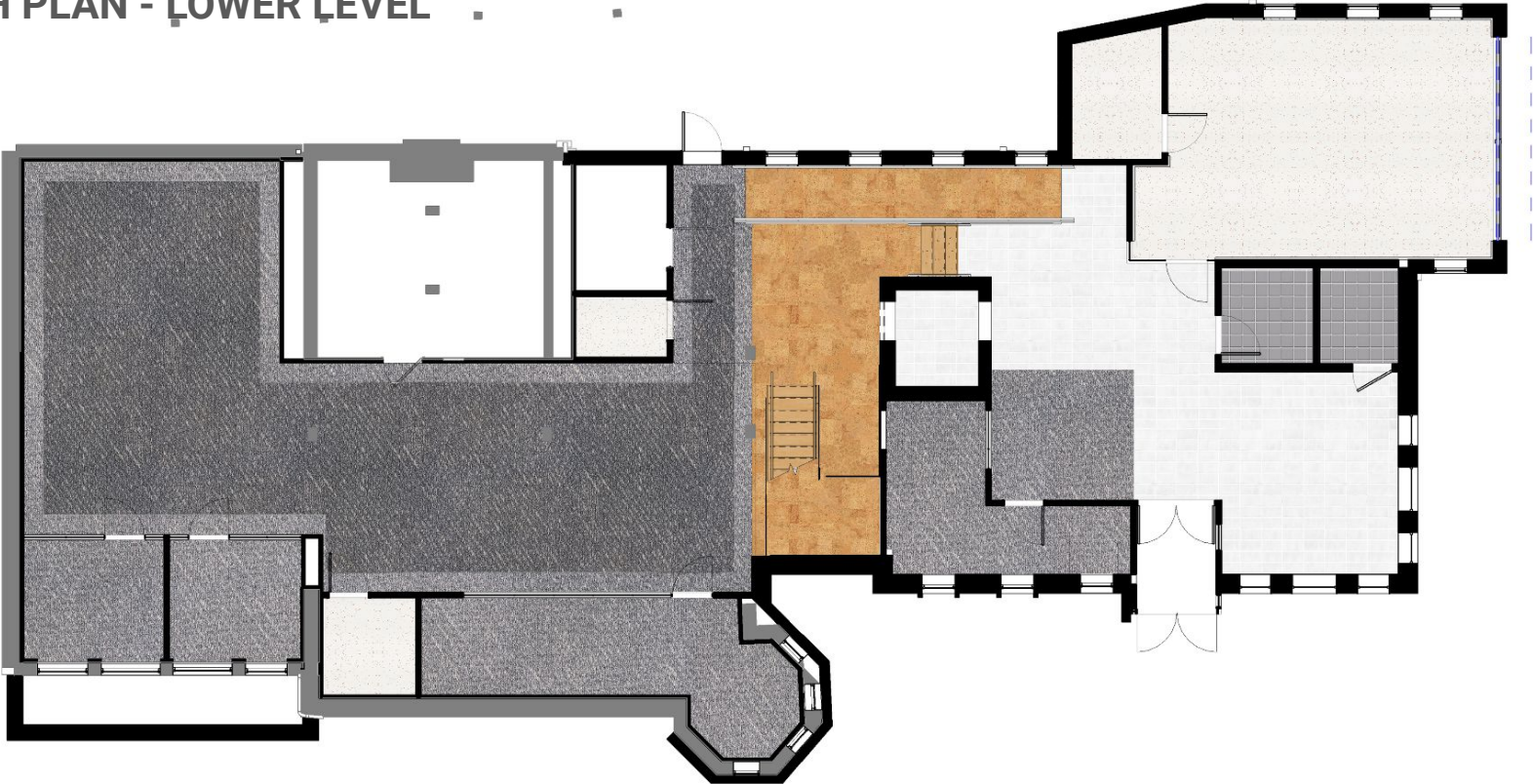

**EXISTING WOOD FLOOR**



**LARGE FORMAT TILE**

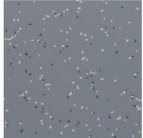

**RESILIENT TILE**



**CORK FLOOR**

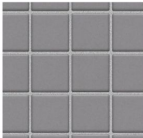

**PORCELAIN TILE  
GREY FLOOR TILE**

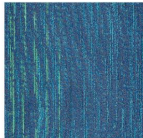

**CARPET TILES**



**CARPET TILES**

# FINISH PLAN - UPPER LEVEL



-   
**LARGE FORMAT  
TILE**
-   
**PORCELAIN TILE  
GREY FLOOR TILE**
-   
**CORK FLOOR**
-   
**CARPET TILES**
-   
**CARPET TILES**
-   
**RESILIENT TILE**



# OVERALL INTERIOR PALETTE

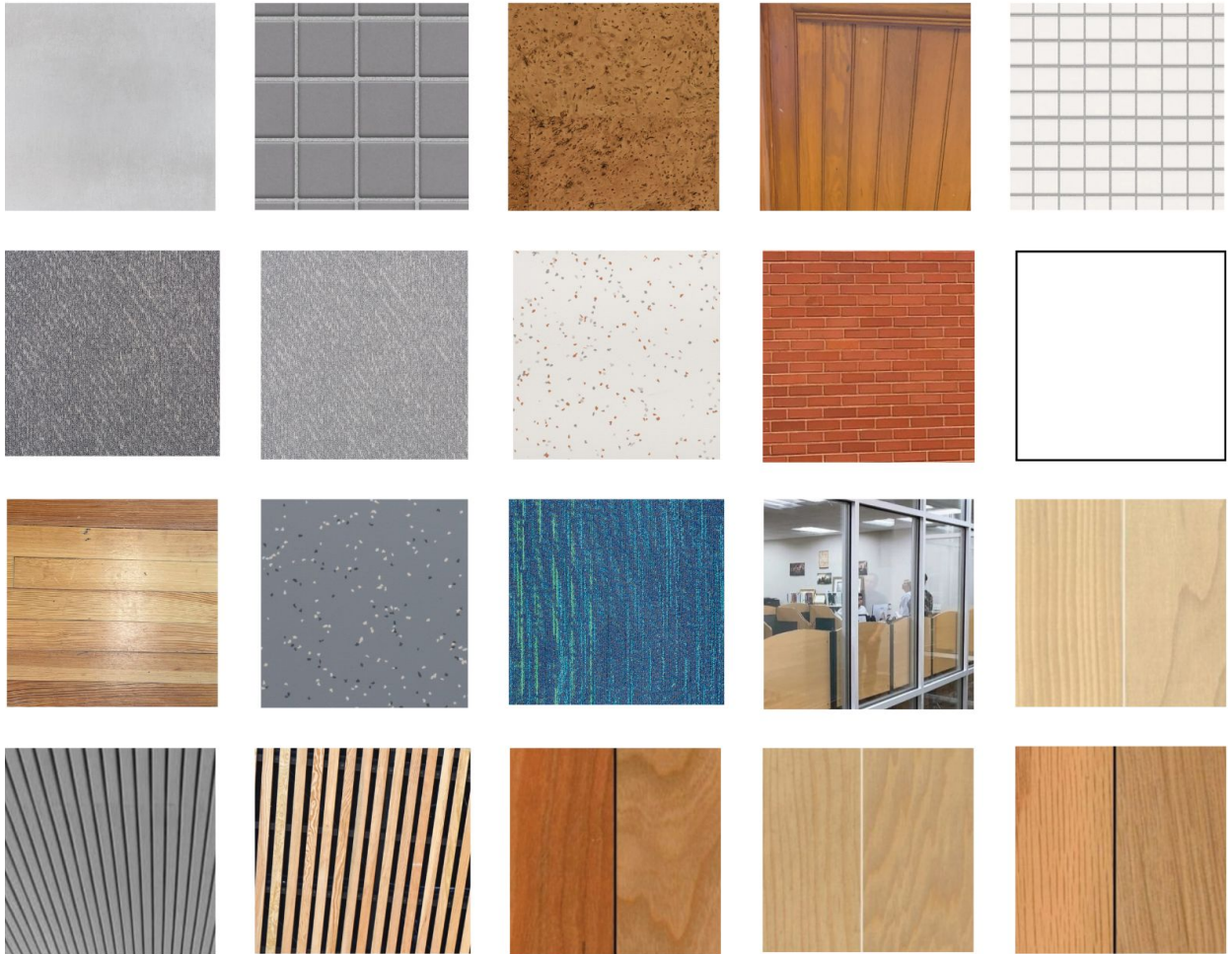

# INTERIOR TURRET/COMMUNITY LIVING ROOM





LOWER LEVEL CIRCULATION



# CIRCULATION GASKET - LOWER LEVEL





# COMMUNITY LIVING ROOM/BROWSING AND ARRIVAL

CEILING

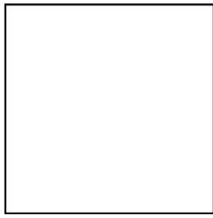

WALL

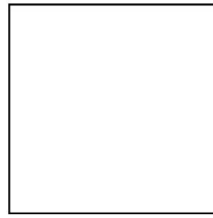

CEILING



PAINTED GYPSUM

PAINTED GYPSUM

LINEAR WOOD  
CLOUD

MILLWORK



WALL



FLOOR



WOOD PANELS

WOOD PANELS

LARGE FORMAT  
TILE



# COMMUNITY FLEX ROOM

CEILING

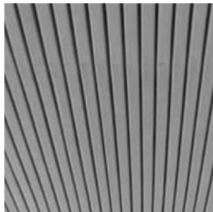

WALL



WAINSCOT



**LINEAR FELT  
CLOUD**

CEILING

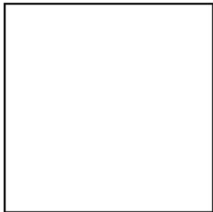

**INTERIOR  
STOREFRONT**

WALL

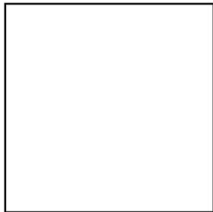

**WOOD PANELS**

FLOOR

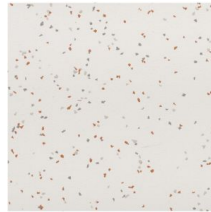

**PAINTED GYPSUM   PAINTED GYPSUM   RESILIENT TILE**



# CIRCULATION

WALL

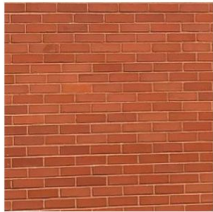

STAIRS

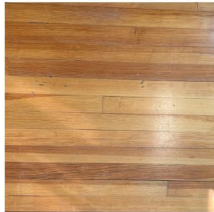

MILLWORK

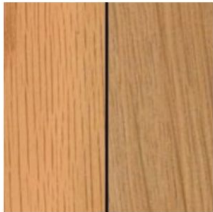

EXISTING BRICK  
WALL

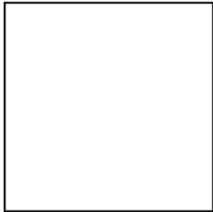

EXISTING WOOD  
FLOOR



WOOD PANELS

FLOOR

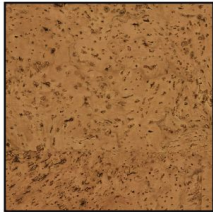

PAINTED GYPSUM  
WITH VINYL GRAPHIC

CORK FLOOR

CORK FLOOR



# CIRCULATION - ELEVATOR





# MEETING ROOMS/TEEN LOUNGE/COLLECTIONS

CEILING

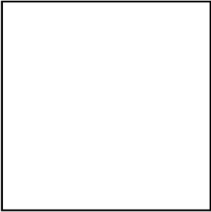

WALL



CEILING

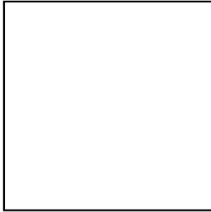

FLOOR



PAINTED GYPSUM

INTERIOR  
STOREFRONT

PAINTED GYPSUM

MAIN CARPET  
TILES

FLOOR



WALL

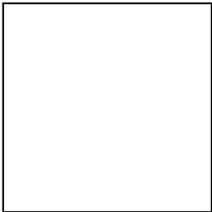

WALL

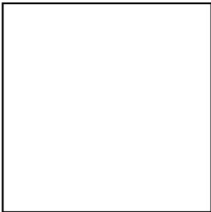

FLOOR



CARPET

PAINTED GYPSUM

PAINTED GYPSUM

ACCENT CARPET



FINISH PLAN - UPPER LEVEL



  
**LARGE FORMAT  
TILE**

  
**PORCELAIN TILE  
GREY FLOOR TILE**

  
**CORK FLOOR**

  
**CARPET TILES**

  
**CARPET TILES**

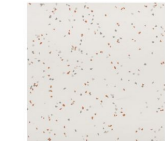
  
**RESILIENT TILE**



# CHILDREN'S COLLECTION



# CIRCULATION GASKET - UPPER LEVEL





# CHILDREN'S SPACE

CEILING



WALL



FLOOR

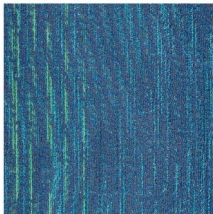

LINEAR WOOD  
CLOUD

CEILING

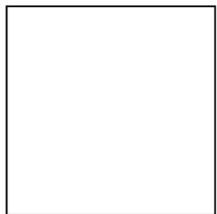

INTERIOR  
STOREFRONT

WALL

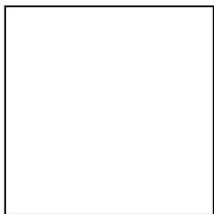

ACCENT CARPET  
TILES

FLOOR



FLOOR



PAINTED GYPSUM PAINTED GYPSUM

MAIN CARPET  
TILES

RESILIENT TILES



# HISTORIC ROOMS

MILLWORK



WALL



WOOD PANELS

EXISTING  
WAINSCOTTING

CEILING

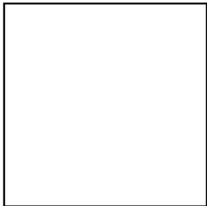

WALL

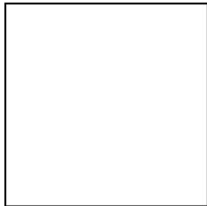

FLOOR

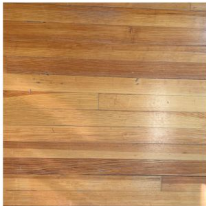

PAINTED EXISTING  
PLASTER

PAINTED EXISTING  
PLASTER

EXISTING WOOD  
FLOOR





# DISCUSSION



# Today's Agenda

## Introduction

- Review Work Plan + Process Updates

## 65% Estimate Review

## Interior Characteristic

## Exterior Characteristic

## Discussion + Next Steps





# OVERALL SITE PLAN



# HISTORIC CONTEXT

## RANDALL COMPOSITION

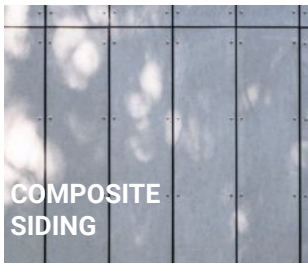
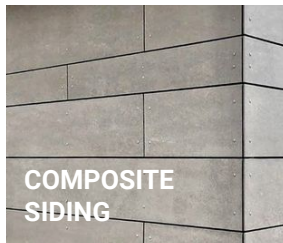
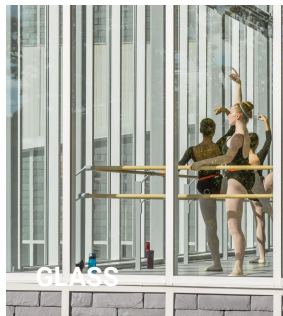



# LANDSCAPE PLANTINGS

## TREES



red maple



european hornbeam



black tupelo



swamp white oak



red oak

## GROUNDCOVERS



sensitive fern



barren strawberry



vinca



low blueberry bush



cranesbill



sweetspire



lo-gro sumac



spirea

## SHRUBS



little lime hydrangea



oakleaf hydrangea



swamp azalea



bayberry



bottlebrush buckeye



viburnum



red twig dogwood



siberian cypress



blue holly

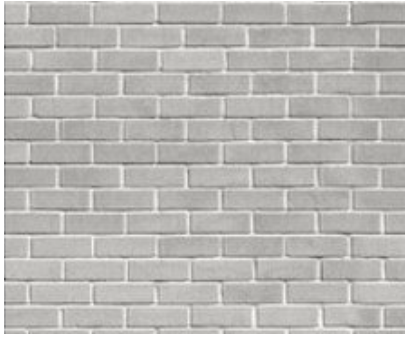
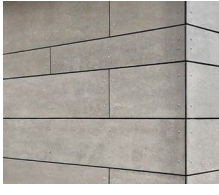
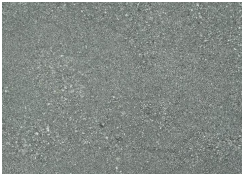



**EXISTING BUILDING DETAIL**





# PROPOSED EXTERIOR ANALYSIS

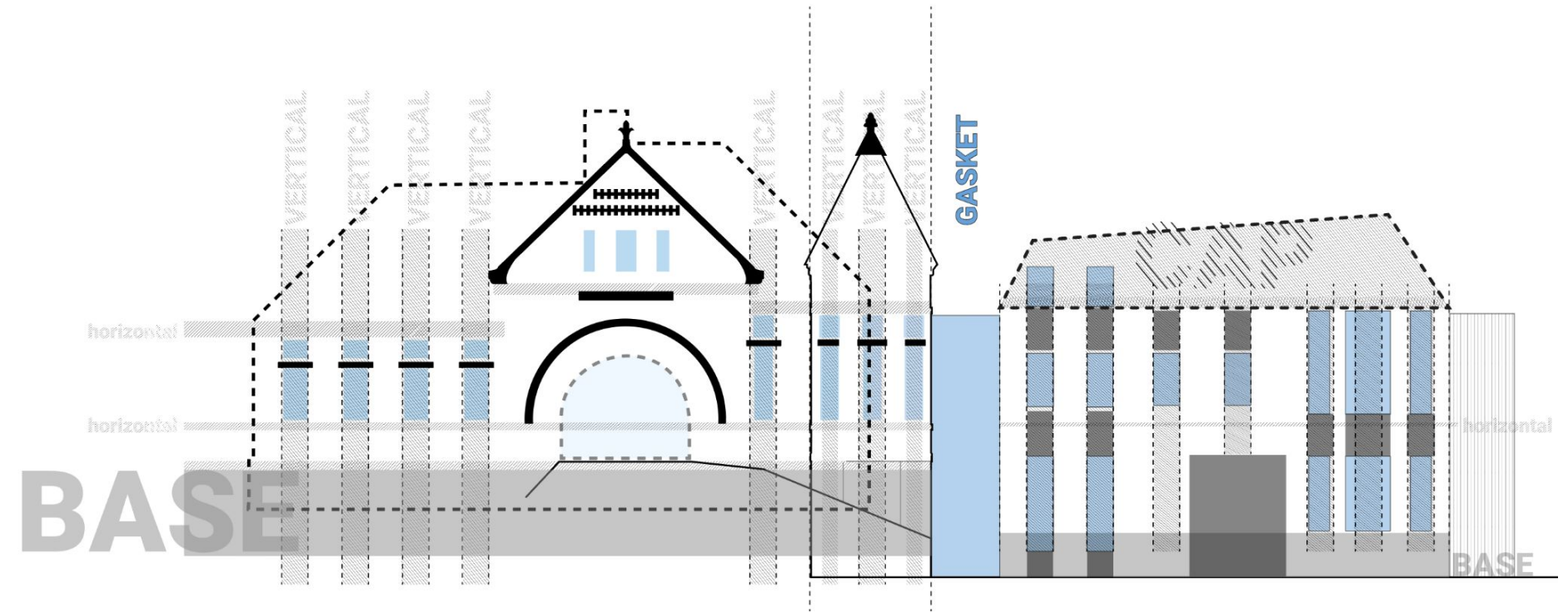

# PREVIOUS PROPOSED EXTERIOR COMPOSITION

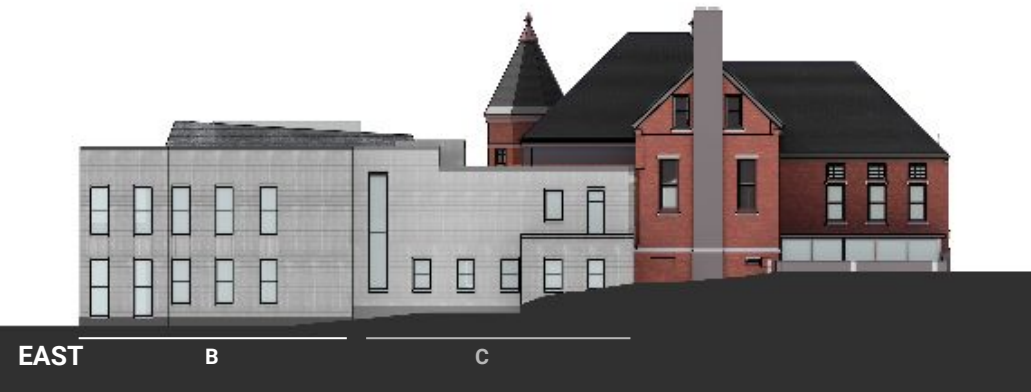







# SOUTHWEST APPROACH









# SOUTHEAST APPROACH

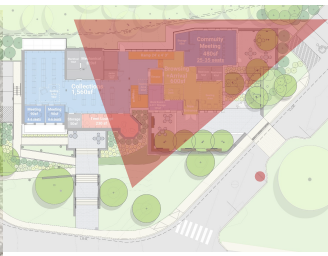











# Today's Agenda

## Introduction

- Review Work Plan + Process Updates

## 65% Estimate Review

## Interior Characteristic

## Exterior Characteristic

## Discussion + Next Steps



NEXT STEPS

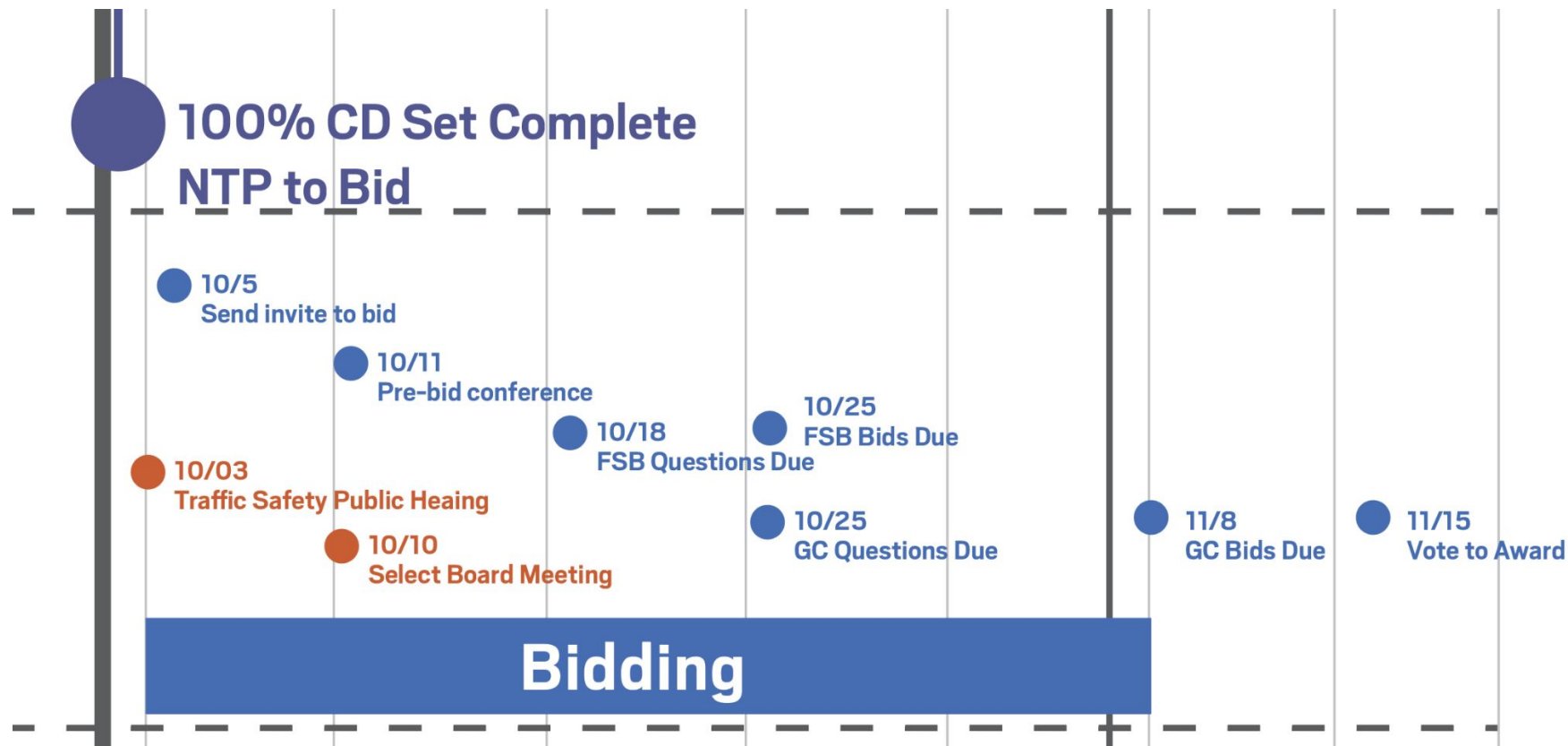



A photograph of a brick building, identified as the Randal Library, featuring a large arched window and a sign above it. The image is overlaid with a teal color and the text 'THANK YOU!!!'.

THANK YOU!!!

**End**



# LOCATING PERSPECTIVE



The main image is a perspective architectural rendering of a building complex. On the left, there is a historic-style building constructed from reddish-brown stone, featuring a prominent gabled roof with a small cupola and arched windows. This historic structure is integrated with a modern, two-story extension made of light-colored concrete or stone with large, vertical glass panels. The building is situated on a grassy slope, with a paved walkway and a low stone wall in the foreground. The background shows a line of trees and a hazy sky. In the top right corner, there is an inset site plan map. The map shows a larger area with various colored zones (green for landscaping, blue for water, yellow for parking, and red for building footprints). A red triangle is drawn on the map, pointing to the specific location of the building shown in the main rendering. Labels on the map include 'PARKING', 'LIBRARY', 'COMMODITY', and 'BREWING'.



# UPDATED PLAN - LOWER LEVEL





# UPDATED PLAN - UPPER LEVEL

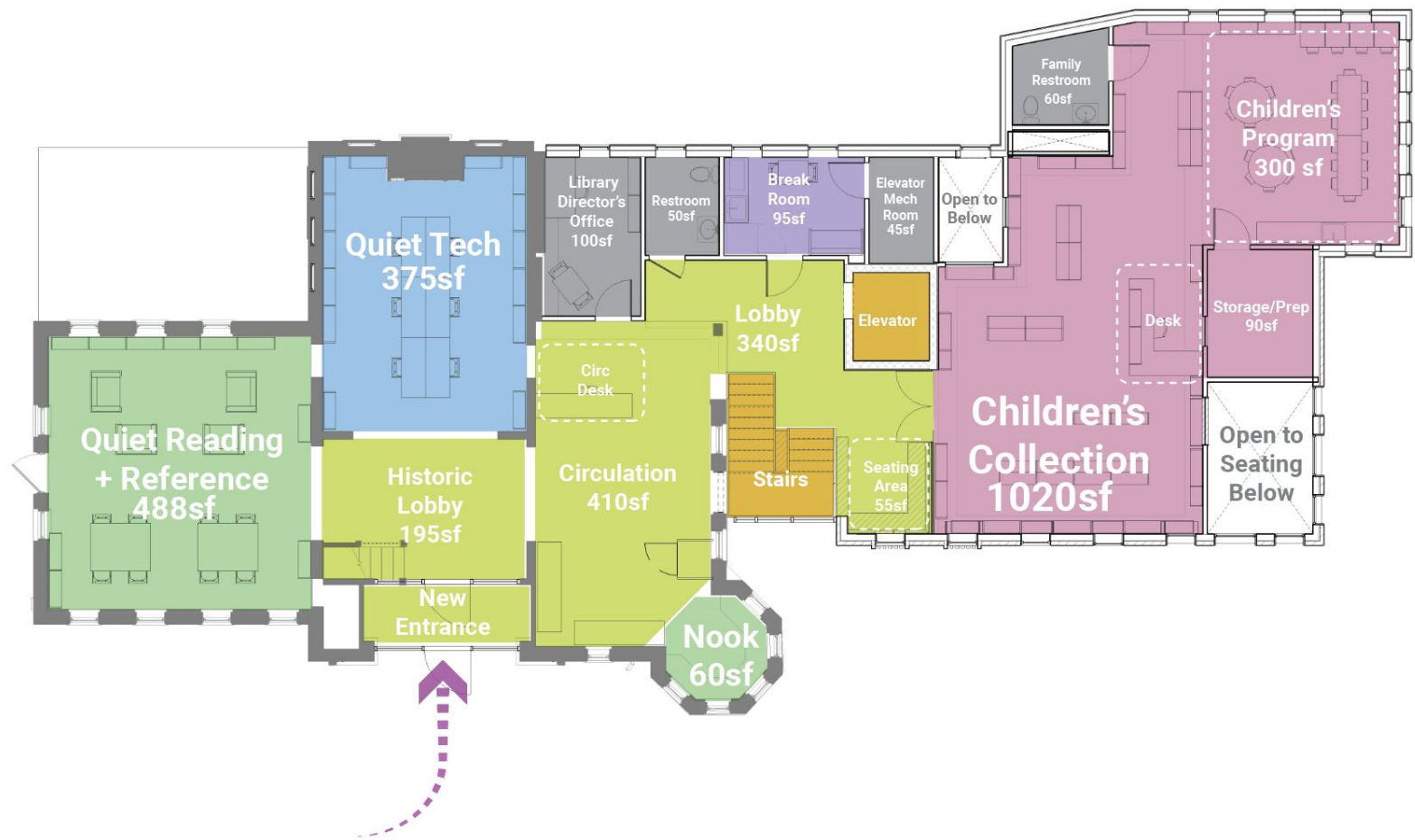

# LANDSCAPE UPDATED PLAN

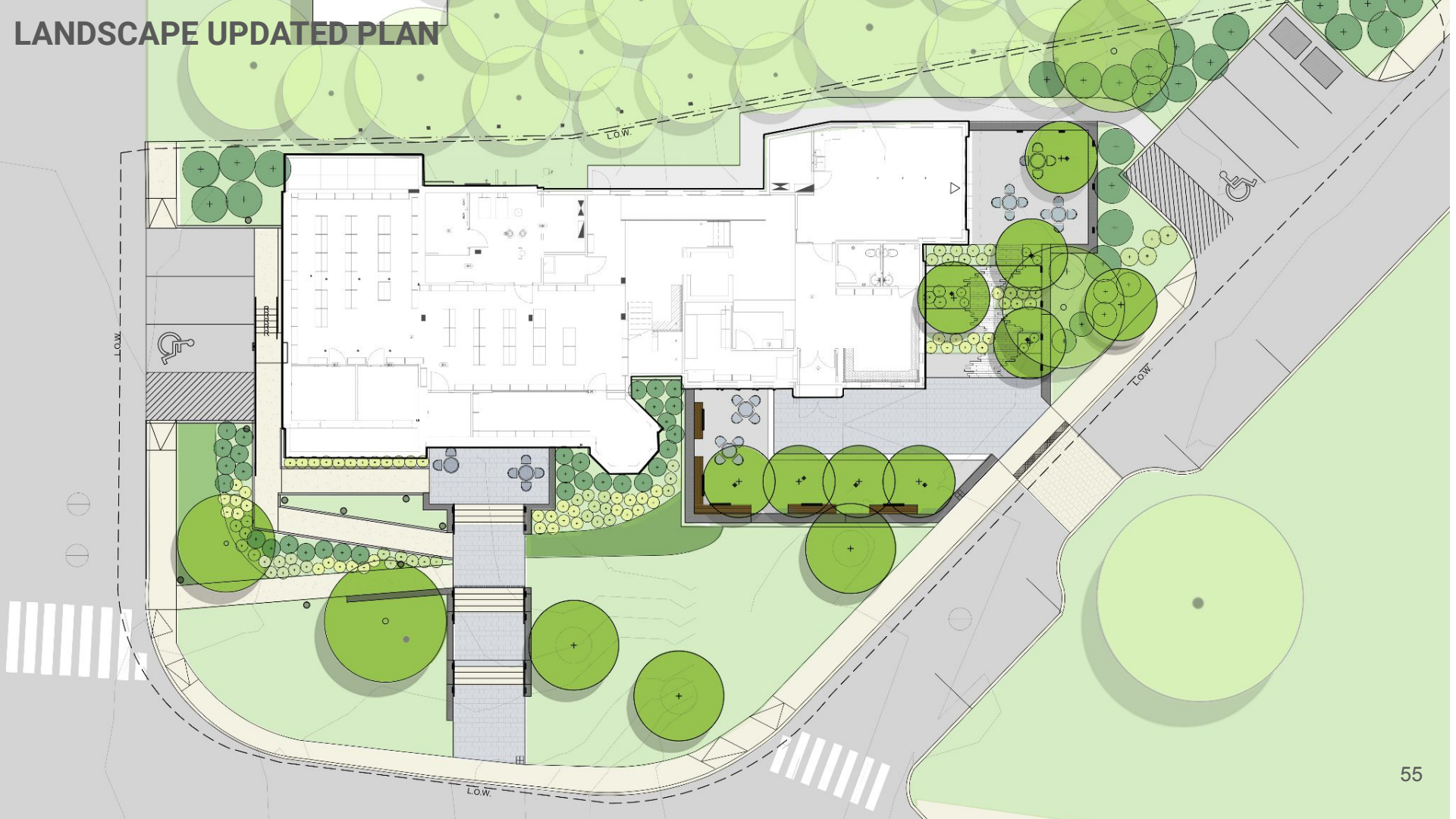



# LANDSCAPE UPDATED PLAN

