



# Massachusetts Department of Environmental Protection

Bureau of Water Resources - Wetlands

## WPA Form 1- Request for Determination of Applicability

Massachusetts Wetlands Protection Act M.G.L. c. 131, §40

Municipality \_\_\_\_\_

### A. General Information

**Important:**  
When filling out  
forms on the  
computer, use only  
the tab key to move  
your cursor - do not  
use the return key.



1. Applicant:

Jane

First Name

Wilmot

Last Name

80 Boxboro Rd.

Address

Stow

City/Town

303-818-6912

Phone Number

MA

State

01775

Zip Code

janewilmot@gmail.com

Email Address

**RECEIVED**

2. Property Owner (if different from Applicant):

First Name

Last Name

APR 17 2024

Address

TOWN OF STOW

CONSERVATION COMMISSION

City/Town

State

Zip Code

Phone Number

Email Address (if known)

3. Representative (if any)

First Name

Last Name

Company Name

Address

City/Town

State

Zip Code

Phone Number

Email Address (if known)

### B. Project Description

1. a. Project Location (use maps and plans to identify the location of the area subject to this request):

80 Boxboro Rd

Street Address

Stow

City/Town

42.444

Latitude (Decimal Degrees Format with 5 digits after decimal  
e.g. XX.XXXXX)

-71.507

Longitude (Decimal Degrees Format with 5 digits after  
decimal e.g. -XX.XXXXX)

R17

Assessors' Map Number

8-1

Assessors' Lot/Parcel Number

b. Area Description (use additional paper, if necessary):

Addition to rear of home

c. Plan and/or Map Reference(s): (use additional paper if necessary)

Title

Date

Title

Date

How to find Latitude  
and Longitude

and how to convert  
to decimal degrees



**Massachusetts Department of Environmental Protection**  
**Bureau of Water Resources - Wetlands**

**WPA Form 1- Request for Determination of Applicability**

Massachusetts Wetlands Protection Act M.G.L. c. 131, §40

\_\_\_\_\_  
Municipality

**B. Project Description (cont.)**

2. a. Activity/Work Description (use additional paper and/or provide plan(s) of Activity, if necessary):

b. Identify provisions of the Wetlands Protection Act or regulations which may exempt the applicant from having to file a Notice of Intent for all or part of the described work (use additional paper, if necessary).

3. a. If this application is a Request for Determination of Scope of Alternatives for work in the Riverfront Area, indicate the one classification below that best describes the project.

- ☒ Single family house on a lot recorded on or before 8/1/96
- ☐ Single family house on a lot recorded after 8/1/96
- ☐ Expansion of an existing structure on a lot recorded after 8/1/96
- ☐ Project, other than a single-family house or public project, where the applicant owned the lot before 8/7/96
- ☐ New agriculture or aquaculture project
- ☐ Public project where funds were appropriated prior to 8/7/96
- ☐ Project on a lot shown on an approved, definitive subdivision plan where there is a recorded deed restriction limiting total alteration of the Riverfront Area for the entire subdivision
- ☐ Residential subdivision; institutional, industrial, or commercial project
- ☐ Municipal project
- ☐ District, county, state, or federal government project
- ☐ Project required to evaluate off-site alternatives in more than one municipality in an Environmental Impact Report under MEPA or in an alternatives analysis pursuant to an application for a 404 permit from the U.S. Army Corps of Engineers or 401 Water Quality Certification from the Department of Environmental Protection.

b. Provide evidence (e.g., record of date subdivision lot was recorded) supporting the classification above (use additional paper and/or attach appropriate documents, if necessary.)



**Massachusetts Department of Environmental Protection**

Bureau of Water Resources - Wetlands

**WPA Form 1- Request for Determination of Applicability**

Massachusetts Wetlands Protection Act M.G.L. c. 131, §40

Municipality \_\_\_\_\_

**C. Determinations**

1. I request the Stow Conservation Commission make the following determination(s). Check any that apply:

- ☐ a. whether the **area** depicted on plan(s) and/or map(s) referenced above is an area subject to jurisdiction of the Wetlands Protection Act.
- ☐ b. whether the **boundaries** of resource area(s) depicted on plan(s) and/or map(s) referenced above are accurately delineated.
- ☒ c. whether the **Activities** depicted on plan(s) referenced above is subject to the Wetlands Protection Act and its regulations.
- ☒ d. whether the area and/or Activities depicted on plan(s) referenced above is subject to the jurisdiction of any **municipal wetlands' ordinance or bylaw** of:

Stow  
Name of Municipality

- ☐ e. whether the following **scope of alternatives** is adequate for Activities in the Riverfront Area as depicted on referenced plan(s).

**D. Signatures and Submittal Requirements**

I hereby certify under the penalties of perjury that the foregoing Request for Determination of Applicability and accompanying plans, documents, and supporting data are true and complete to the best of my knowledge.

I further certify that the property owner, if different from the applicant, and the appropriate DEP Regional Office were sent a complete copy of this Request (including all appropriate documentation) simultaneously with the submittal of this Request to the Conservation Commission.

Failure by the applicant to send copies in a timely manner may result in dismissal of the Request for Determination of Applicability.

Signatures:

I also understand that notification of this Request will be placed in a local newspaper at my expense in accordance with Section 10.05(3)(b)(1) of the Wetlands Protection Act regulations.

Signature of Applicant

Date

4/10/24

Signature of Representative (if any)

Date

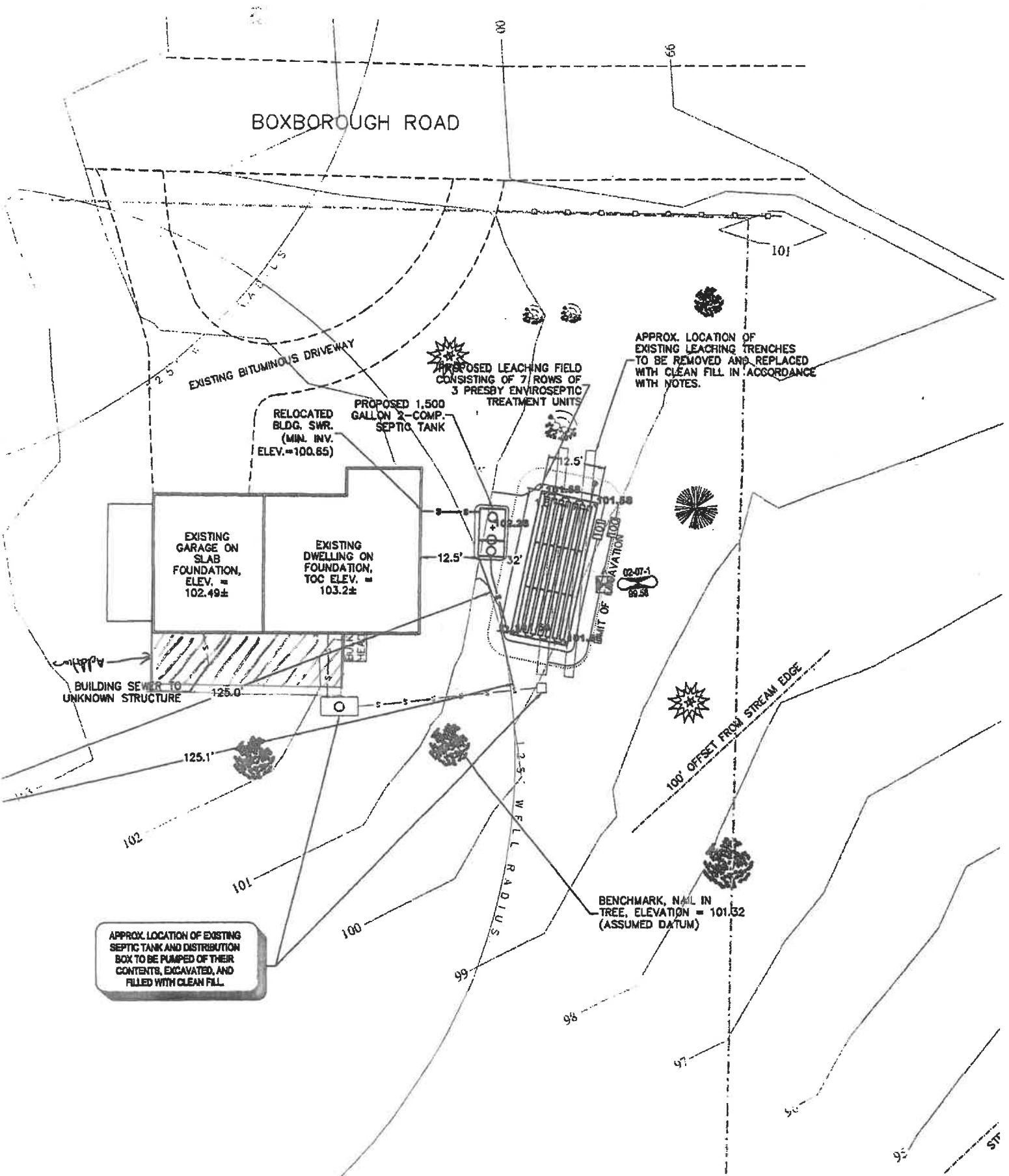

PROPERTY N/F BELONGING TO: HELEN K  
 GRAFF, TOWN OF BOXBOROUGH  
 RECORDED MAP 0 47107 0

# Massachusetts Interactive Property Map

Details

Layers

Basemap

Measure

## To access parcel information:

- **Enter an address** or **zoom in** by using the +/- tools or your mouse scroll wheel. **Parcels will draw when zoomed in.**
- **Click on a parcel** to display a popup with information about that parcel.

Click the **"Basemap"** button to display background aerial imagery.

From the **"Layers"** button you can turn map features on and off. Check on 'Download Parcel Data by City/Town' and click in the map for links to download all parcel data for that municipality.

[Complete Help \(PDF\)](#)

## Parcel Legend:

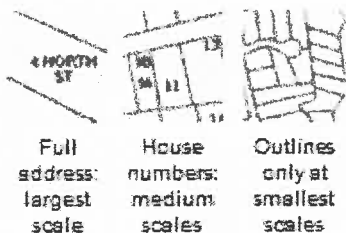

[Full Map Legend](#)

## About this Viewer

The map displays land property boundaries from assessor parcel maps across Massachusetts. Parcel information is from local assessor databases. [More...](#)

[Read about and download parcel data](#)

Also available: an accessible, non-map-based [Property Information Finder](#)

**DISCLAIMER: Assessor's parcel mapping is a representation of property boundaries, not an authoritative source. The authoritative record of property**

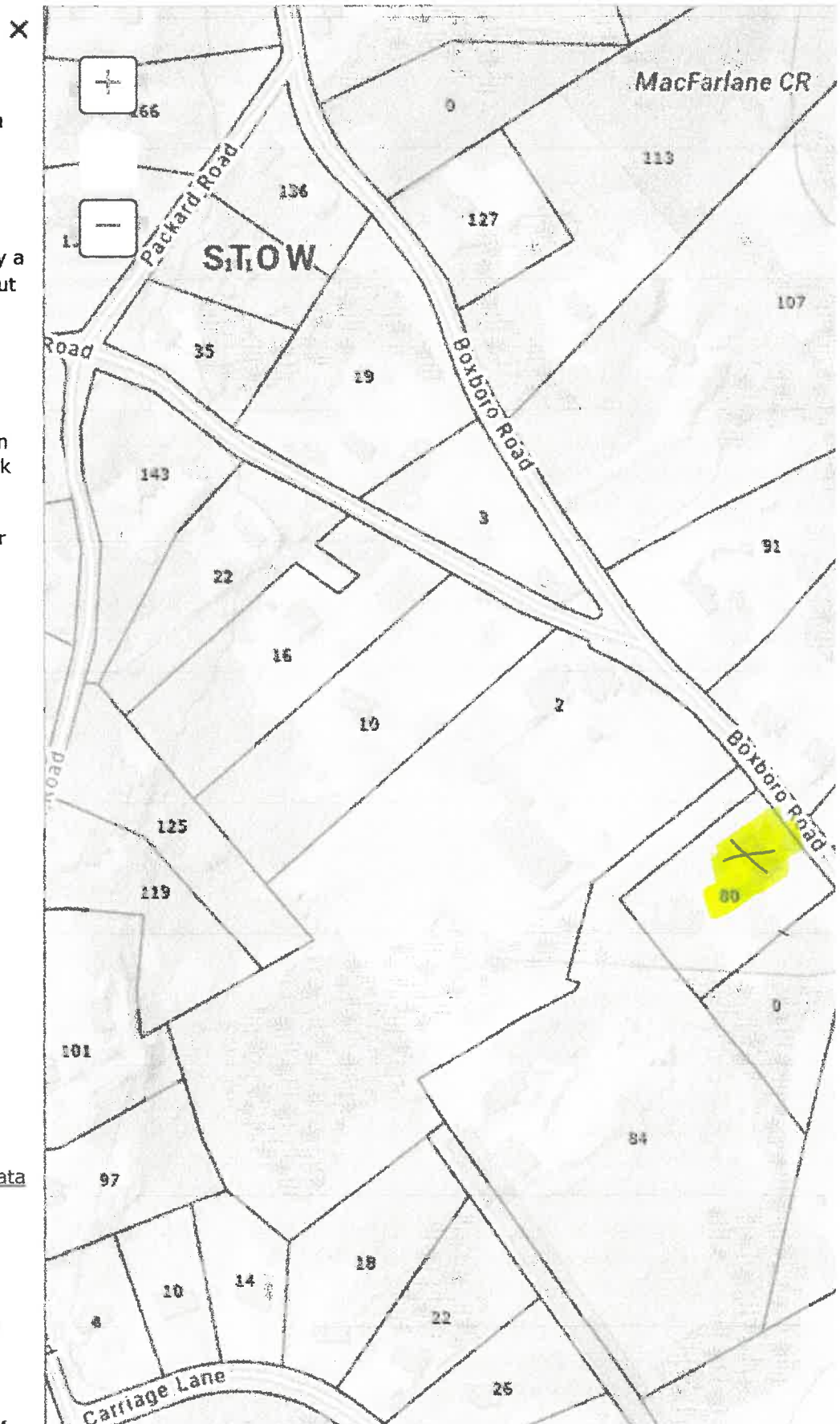

ABUTTERS LIST  
80 BOXBORO RD  
MAP R-17 PARCEL 8-1

MAP/PARCEL	PROPERTY LOCATION	OWNER NAME 1	OWNER NAME 2	MAILING ADDRESS	CITY	STATE	ZIP CODE	DEED BOOK	DEED PAGE
00R-17 000005	64 BOXBORO RD	HOLMGREN ERIK	HOLMGREN ELIZABETH A	64 BOXBORO RD	STOW	MA	01775	60305	67
00R-17 000006	72 BOXBORO RD	SPRUNG, MELANIE LAURA (TTEE), LAURA SPRUNG REV DEC OF TRUST	SAYLER, BRADLEY R. (TTEE), BRADLEY R. SAYLER REV DEC OF TRUST	72 BOXBORO RD	STOW	MA	01775	29054	320
00R-17 000009	84 BOXBORO RD	ALBRIGHT ROBERT T	ANNETTE L ALBRIGHT	84 BOXBORO RD	STOW	MA	01775	21957	295
00R-17 000010	2 TAYLOR RD	MCFARLAND JOHN P	MCFARLAND MARIA M	2 TAYLOR ROAD	STOW	MA	01775	70185	512
00R-17 000088	0 BOXBORO RD	SPRUNG, MELANIE LAURA (TTEE), LAURA SPRUNG REV DEC OF TRUST	SAYLER, BRADLEY R. (TTEE), BRADLEY R. SAYLER REV DEC OF TRUST	72 BOXBORO RD	STOW	MA	01775	25100	193
00R-17 0008-1	80 BOXBORO RD	WILMOT JANE	ROSENBUSCH MICHAEL H	80 BOXBORO RD	STOW	MA	01775	64687	491
00R-18 000035	83 BOXBORO RD	CHEVALIER, THOMAS J.	KOSTECKI, ANINA	83 BOXBORO RD	STOW	MA	01775	21094	89
00R-18 000036	55 BOXBORO RD	GARRY P BALBONI & JENNIE LEE COLOSI TRUS	BALBONI GARRY & JENNY LEE COLOSI TRS	55 BOXBORO RD	STOW	MA	01775	50439	178
00R-18 0035-1	91 BOXBORO RD	KHARTI AVNI	FEIN PETER	91 BOXBORO RD	STOW	MA	01775	71165	595
00R-18 0035-2	77 BOXBORO RD							40893	396

Certified by the Stow Board of Assessors: Gregory Flannery Date Certified or Re-Certified: 4/12/24 Ft: 300



## Town of Stow Conservation Commission

380 Great Road  
Stow, Massachusetts 01775

(978) 897-8615

FAX (978) 897-4534

conservation@stow-ma.gov

### Affidavit of Service Under the Massachusetts Wetlands Protection Act and the Town of Stow Wetlands Bylaw

*(to be submitted to Stow Conservation Commission and MA Department of Environmental  
Protection when filing a Notice of Intent or Request for Determination)*

I, Jane Wilmot (name), hereby certify under the pains and  
penalties of perjury that on 4-16-24 (date of mailing), I gave notification  
to abutters in compliance with the second paragraph of Massachusetts General Laws Chapter  
131, Section 40 and/or the Stow Wetlands Bylaw, in connection with the following matter:

- ☒ Request for Determination (via regular mail)  
☐ Abbreviated Notice of Resource Area Delineation  
(via certified mail or certificate of mailing)  
☐ Notice of Intent (via certified mail or certificate of mailing)

For property located at: 80 Boxboro Rd.

Signature [Signature]

Date 4/15/24